



James *J* LaurenceTM
Sales and Lettings

APARTMENT 26, METALWORKS APARTMENTS, 93
WARSTONE LANE, JEWELLERY QUARTER, BIRMINGHAM
CITY CENTRE, B18 6PX ASKING PRICE OF £239,950





DESCRIPTION

****EWS1 FORM GRANTED** **NO UPWARD CHAIN**** A beautifully presented two bedroom apartment located in the Metalworks development. The apartment benefits from having open plan living area/fitted kitchen with integrated appliances, two bedrooms and a stylish bathroom as well as a secure allocated parking space. Metalworks is a secure gated development with communal gardens in the heart of the Jewellery Quarter.

ENTRANCE HALLWAY

6' 36 (Max)" x 12' 36" (2.74m x 4.57m)

OPEN PLAN LIVING KITCHEN/ DINER

22' 68" x 11' 77" (8.43m x 5.31m)

MASTER BEDROOM

9' 9" x 17' 36" (2.97m x 6.1m)

BEDROOM TWO

17' 2" x 9' (5.23m x 2.74m)

FAMILY BATHROOM

10' 16" x 6' 26" (3.45m x 2.49m)

STORAGE

The property has two internal storage cupboards.

OUTSIDE

Secure gated development with communal gardens.

PARKING

The property comes with one allocated parking space.

AREA

The Jewellery Quarter is a designated conservation area and proposed World Heritage Site and is already a prestigious and highly desired part of Birmingham. It is experiencing further development as some of the old factories are converted into apartments, restaurants and shops. It is only a short distance to all that Birmingham City Centre has to offer. Metalworks is located in the heart of this historic district.

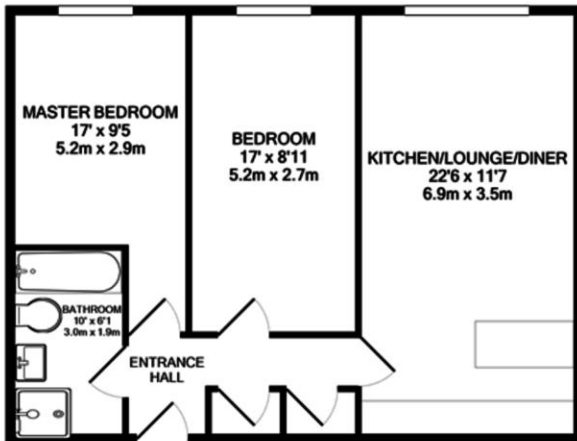

Whilst every attempt has been made to ensure the accuracy of the floor plan contained here, measurements of doors, windows, rooms and any other items are approximate and no responsibility is taken for any error, omission, or mis-statement. This plan is for illustrative purposes only and should be used as such by any prospective purchaser. The services, systems and appliances shown have not been tested and no guarantee as to their operability or efficiency can be given
Made with Metropix ©2019

