



James *J* Laurence<sup>TM</sup>  
Sales and Lettings

APARTMENT 1607, THE CUBE EAST, 196 WHARFSIDE STREET, BIRMINGHAM CITY CENTRE, B1 1PR  
ASKING PRICE OF £160,000



James Laurence *J*



**DESCRIPTION**

**\*\*EWS1 FORM GRANTED\*\*** A superb one bedroom apartment with fabulous views and benefitting from an private balcony. The Cube East development is the benchmark for city living in Birmingham, a ground breaking specification, location, amenities and views all add up to make this a very desirable city centre proposition.

This well-appointed apartment offers approximately 516 sq. ft. of accommodation.

**ENTRANCE HALLWAY**

**LIVING ROOM**

15' 8" x 13' 5" (4.78m x 4.09m)

**KITCHEN**

9' 9" x 6' 0" (2.97m x 1.83m)

**MASTER BEDROOM**

10' 10" x 9' 5" (3.3m x 2.87m)

**PRIVATE BALCONY**

**FAMILY BATHROOM**

8' 7" x 5' 5" (2.62m x 1.65m)

**AREA**

Truly considered one of the most enthralling additions to Birmingham's ever-changing skyline. The Cube is a world-class destination located in the heart of Birmingham City. It is home to a vibrant mix of indulgent restaurants and bars, the Indigo hotel, luxury spa and gym along with prestigious residential apartments.

This 25-storey structure also includes the UK's largest automated car park and is surrounded by The Mailbox complex, Commercial Street, Washington Wharf apartment complex and overlooks Birmingham Canal.

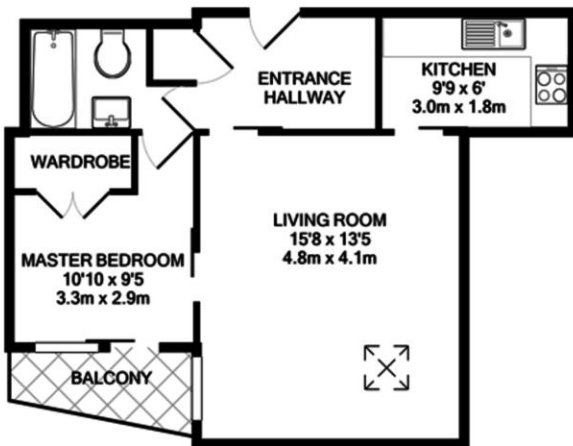

**TOTAL APPROX. FLOOR AREA 516 SQ.FT. (47.9 SQ.M.)**

Whilst every attempt has been made to ensure the accuracy of the floor plan contained here, measurements of doors, windows, rooms and any other items are approximate and no responsibility is taken for any error, omission, or mis-statement. This plan is for illustrative purposes only and should be used as such by any prospective purchaser. The services, systems and appliances shown have not been tested and no guarantee as to their operability or efficiency can be given  
Made with Metropix ©2020

