



The Cube East

Birmingham City Centre

B1 1PR

Auction Guide Price £130,000

One Bedroom Apartment

Private Balcony

Sixteenth Floor

Iconic Development





Property Description

DESCRIPTION **EWS1 FORM GRANTED** A superb one bedroom apartment with fabulous views and benefiting from an private balcony. The Cube East development is the benchmark for city living in Birmingham, a ground breaking specification, location, amenities and views all add up to make this a very desirable city centre proposition. This well-appointed apartment offers approximately 516 sq. ft. of accommodation.

ENTRANCE HALLWAY

LIVING ROOM 15' 8" x 13' 5" (4.78m x 4.09m)

KITCHEN 9' 9" x 6' 0" (2.97m x 1.83m)

MASTER BEDROOM 10' 10" x 9' 5" (3.3m x 2.87m)

PRIVATE BALCONY

FAMILY BATHROOMS 7" x 5' 5" (2.62m x 1.65m)

AREA

Truly considered one of the most enthralling additions to Birmingham's ever-changing skyline. The Cube is a world-class destination located in the heart of Birmingham City. It is home to a vibrant mix of indulgent restaurants and bars, the Indigo hotel, luxury spa and gym along with prestigious residential apartments. This 25-storey structure also includes the UK's largest automated car park and is surrounded by The Mailbox complex, Commercial Street, Washington Wharf apartment complex and overlooks Birmingham Canal.

UNDER THE HAMMER BIDDING

For bidding please visit: underthehammer.com

***START PRICES & RESERVE PRICES**

Each property sold is subject to a Reserve Price. The Reserve Price will be within + or - 10% of the Start Price. The Start Price is issued solely as a guide so that a buyer can consider whether or not to pursue their interest.

VIEWING DETAILS

By arrangement with the partner agents or contact.

UNCONDITIONAL AUCTION DETAILS

Contracts are exchanged immediate at the end of the auction and a 5% deposit subject to a minimum of £5,000 will be taken from the highest bidder. **THIS DEPOSIT WILL CONTRIBUTE TOWARDS THE PURCHASE PRICE.**

Completion will be 8 Weeks (56 days) which means interested parties can proceed with traditional residential finance.

Every buyer must first create an account at underthehammer.com. Remote bidding facilities are also available, contact the auction office for further details.

FULL TERMS & LEGAL DOCUMENTS

Available at underthehammer.com

Floor Layout

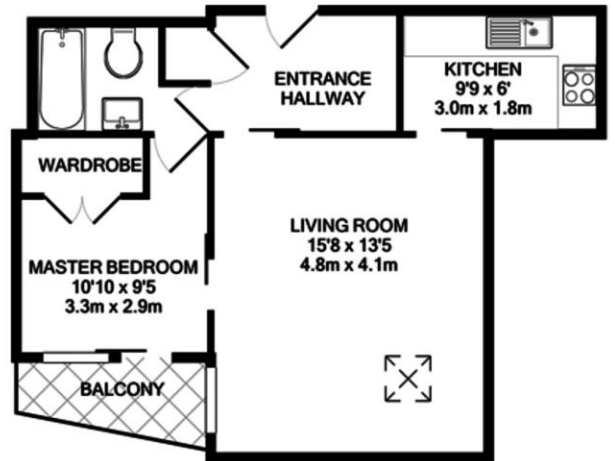

TOTAL APPROX. FLOOR AREA 516 SQ.FT. (47.9 SQ.M.)

Whilst every attempt has been made to ensure the accuracy of the floor plan contained here, measurements of doors, windows, rooms and any other items are approximate and no responsibility is taken for any error, omission, or mis-statement. This plan is for illustrative purposes only and should be used as such by any prospective purchaser. The services, systems and appliances shown have not been tested and no guarantee as to their operability or efficiency can be given. Made with Metropix ©2020

Total approx. floor area 516 sq ft (48 sq m)

Whilst every attempt has been made to ensure the accuracy of the floor plan contained here, measurements of doors, windows, rooms and any other items are approximate and no responsibility is taken for any error, omission, or mis-statement. This plan is for illustrative purposes only and should be used as such by any prospective purchaser. The services, systems and appliances shown have not been tested and no guarantee as to their operability or efficiency can be given. Made with Metropix ©2019.



Energy efficiency Rating		Environmental Impact (CO ₂) Rating	
Energy Efficiency	Score	Environmental Impact	Score
Very energy efficient - lower running costs	45	Very environmentally friendly - lower CO ₂ emissions	45
A	45	A	45
B	44	B	44
C	43	C	43
D	42	D	42
E	41	E	41
F	40	F	40
G	39	G	39

Birmingham City Centre Branch

0121 6044060

info@jameslaurenceuk.com

37-39 Ludgate Hill, Birmingham, B3 1EH



Agents Note: Whilst every care has been taken to prepare these sales particulars, they are for guidance purposes only. All measurements are approximate are for general guidance purposes only and whilst every care has been taken to ensure their accuracy, they should not be relied upon and potential buyers are advised to recheck the measurements