



James *J* LaurenceTM
Sales and Lettings

APARTMENT 2007, THE CUBE EAST, 196 WHARFSIDE STREET, BIRMINGHAM CITY CENTRE, B1 1PT
ASKING PRICE OF £127,500



James Laurence *J*



DESCRIPTION

****EWS1 FORM GRANTED**** This fantastic studio apartment in The Cube East showcases one of Birmingham landmark's to the highest standard. The Cube is a prestigious development offering a variety of high-end restaurants, cafes and bars. Finished to an extremely high spec, this apartment offers contemporary living that is vastly different from other developments in the city.

STUDIO APARTMENT

13' 8 (Max)" x 21' 8 (Max)" (4.17m x 6.6m)

SHOWER ROOM

7' 3" x 4' 7" (2.21m x 1.4m)

AREA

The Cube is one of Birmingham's most iconic buildings and is situated in a central location being just a 0.5 mile walk to New Street Station. There are plenty of bars and restaurants to be found in the local vicinity as well as being a 0.5 miles walk to the ever popular Brindleyplace. The apartment is also just a few floors away from Rodizio Rico, an authentic Brazilian culinary journey with unrivalled canal views, the perfect spot for a dinner al fresco in the British summer sun.

This fantastic apartment needs to be viewed to fully appreciate the space on offer.

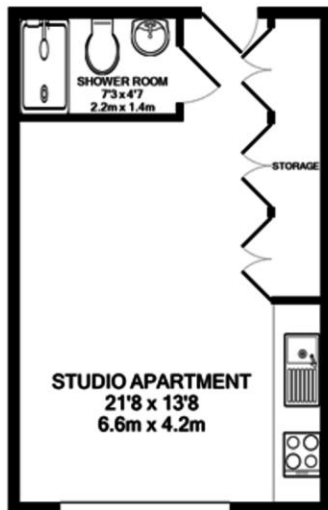

TOTAL APPROX. FLOOR AREA 300 SQ.FT. (27.9 SQ.M.)

Whilst every attempt has been made to ensure the accuracy of the floor plan contained here, measurements of doors, windows, rooms and any other items are approximate and no responsibility is taken for any error, omission, or mis-statement. This plan is for illustrative purposes only and should be used as such by any prospective purchaser. The services, systems and appliances shown have not been tested and no guarantee as to their operability or efficiency can be given
 Made with Metropix ©2020

