



James *J* LaurenceTM
Sales and Lettings

APARTMENT 110, CAMDEN HOUSE, 80 POPE STREET,
JEWELLERY QUARTER, BIRMINGHAM CITY CENTRE, B1
3BH
ASKING PRICE OF £169,950





****EWS1 FORM GRANTED**** Camden House is a stylish residential development in Birmingham's vibrant Jewellery Quarter, set within the new St George's Urban Village scheme. The luxurious one bedroom apartment, located on the first floor offers spacious living and clean contemporary lines without compromising attention to detail. The apartment briefly comprises of:- An entrance hall, open plan living & kitchen area, family bathroom & Master bedroom.

The property is an ideal investment achieving £725.00 Per Calendar Month.



ENTRANCE HALL

OPEN PLAN LIVING & KITCHEN AREA

22' 5" x 10' 1" (6.83m x 3.07m)

MASTER BEDROOM

13' 4" x 10' 1" (4.06m x 3.07m)

FAMILY BATHROOM

6' 8" x 6' 2" (2.03m x 1.88m)

AREA

The property is located in the heart of Birmingham's Jewellery Quarter.

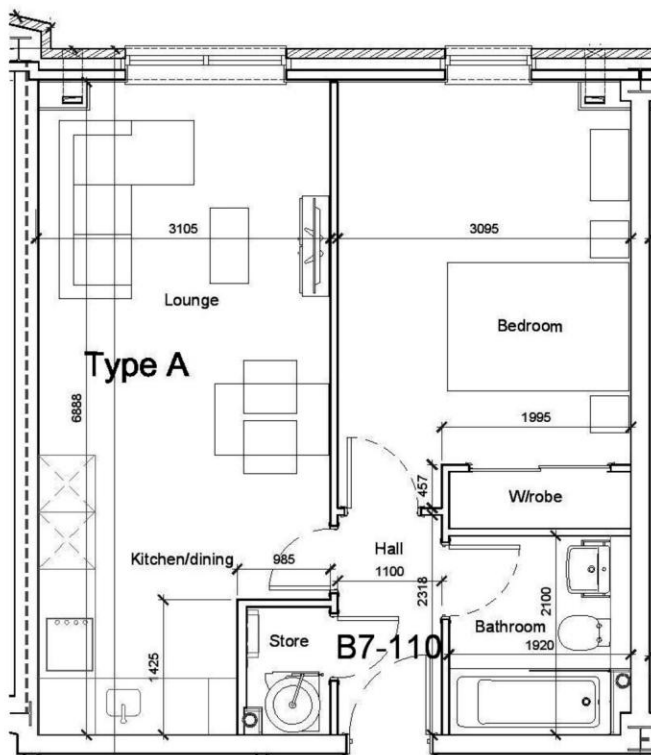

The Jewellery Quarter is a designated conservation area and proposed World Heritage Site and is already a prestigious and highly desired part of Birmingham. It is experiencing further development as some of the old factories are converted into apartments, restaurants and shops. It is only a short distance to all that Birmingham City Centre has to offer including the Colmore Business District.

Energy Efficiency Rating		
	Current	Potential
Very energy efficient - lower running costs		
A (92-100)		
B (81-91)		
C (69-80)	82	82
D (55-68)		
E (39-54)		
F (21-38)		
G (1-20)		
Not energy efficient - higher running costs		
England, Scotland & Wales	EU Directive 2002/91/EC	