

Queens College Chambers

Birmingham City Centre

B1 2AH

Asking Price Of **£275,000**

Large Two-Bedroom Apartment

910 Sq. Ft.

Seventh Floor Apartment

One Secure & Allocated Parking Space



Property Description

DESCRIPTION **EWS1 FORM GRANTED **NO UPWARD CHAIN**** James Laurence are pleased to present a beautifully, spacious two-bedroom apartment with **SECURE ALLOCATED PARKING** in the sought after Queens College Chambers development available offering a great owner occupier, or investment property. Located on Paradise Street, Queens College Chambers is a sympathetically conversion development with a Grade II Listed frontage, benefiting from concierge, communal terrace and lift access.

ENTRANCE HALL

OPEN PLAN LIVING & KITCHEN AREA 15' 5" x 21' 1" (4.7m x 6.43m)

MASTER BEDROOM 15' 10" x 15' 6" (4.83m x 4.72m)

ENSUITE

GUEST BEDROOM 12' 0" x 10' 9" (3.66m x 3.28m)

FAMILY BATHROOM

PARKING The property boasts one secure and allocated parking space.

AREA Situated in between the two most popular locations - The Mailbox and The Financial district. The development overlooks the City's famous Victoria Square and houses a slick concierge service. The area has recently undergone masses of structural improvement with direct tram lines operating frequently on the door step. Also expected to join the spot are an array of new office spaces, restaurants and bars.

Floor Layout

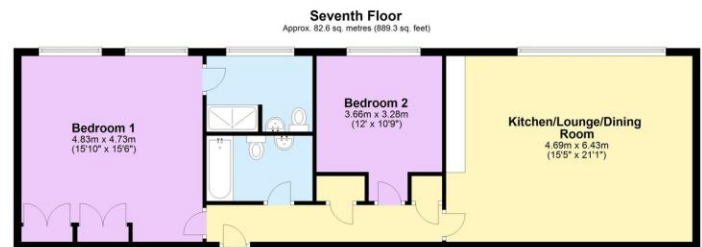

Total area: approx. 82.6 sq. metres (889.3 sq. feet)

Total approx. floor area 910 sq ft (85 sq m)

Whilst every attempt has been made to ensure the accuracy of the floor plan contained here, measurements of doors, windows, rooms and any other items are approximate and no responsibility is taken for any error, omission, or mis-statement. This plan is for illustrative purposes only and should be used as such by any prospective purchaser. The services, systems and appliances shown have not been tested and no guarantee as to their operability or efficiency can be given. Made with Metropix ©2019.



Birmingham City Centre Branch

0121 6044060

info@jameslaurenceuk.com

37-39 Ludgate Hill, Birmingham, B3 1EH

JL
James Laurence

Agents Note: Whilst every care has been taken to prepare these sales particulars, they are for guidance purposes only. All measurements are approximate and for general guidance purposes only and whilst every care has been taken to ensure their accuracy, they should not be relied upon and potential buyers are advised to recheck the measurements