

## Point 4

Jewellery Quarter

B18 6BP

Asking Price Of **£189,950**

*Two Bedroom Apartment*

*Secure & Allocated Parking*

*678 Sq. Ft.*

*No Upward Chain*



## Property Description

**DESCRIPTION \*\*EWS1 FORM GRANTED\*\*** A well presented two bedroom apartment spanning over 678 Sq. Ft. situated in the heart of the Jewellery Quarter. This first floor property briefly comprises: entrance hallway, open plan living/dining room with Juliet balcony off, separate kitchen, master bedroom with en-suite facilities, second double bedroom, family bathroom and secure allocated parking. Ideal purchase for a first time buyer or investor.

**LOCATION** The property is located in the heart of Birmingham's Jewellery Quarter.

The Jewellery Quarter is a designated conservation area and proposed World Heritage Site and is already a prestigious and highly desired part of Birmingham. It is experiencing further development as some of the old factories are converted into apartments, restaurants and shops. It is only a short distance to all that Birmingham City Centre has to offer including the Colmore Business District.

## Floor Layout

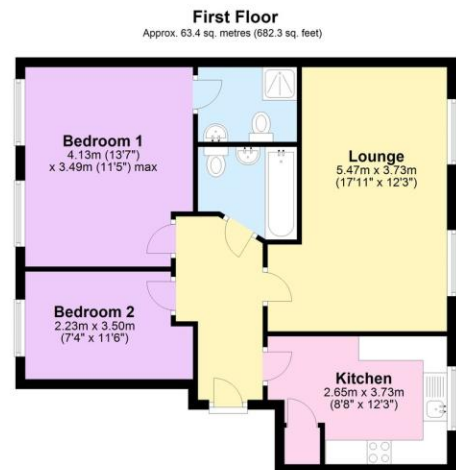

Total area: approx. 63.4 sq. metres (682.3 sq. feet)

Total approx. floor area 687 sq ft (64 sq m)

Whilst every attempt has been made to ensure the accuracy of the floor plan contained here, measurements of doors, windows, rooms and any other items are approximate and no responsibility is taken for any error, omission, or mis-statement. This plan is for illustrative purposes only and should be used as such by any prospective purchaser. The services, systems and appliances shown have not been tested and no guarantee as to their operability or efficiency can be given. Made with Metropix ©2019.



Birmingham City Centre Branch

0121 6044060

info@jameslaurenceuk.com

37-39 Ludgate Hill, Birmingham, B3 1EH

*JL*  
James Laurence

*Agents Note: Whilst every care has been taken to prepare these sales particulars, they are for guidance purposes only. All measurements are approximate and for general guidance purposes only and whilst every care has been taken to ensure their accuracy, they should not be relied upon and potential buyers are advised to recheck the measurements*