



## Kings Court

St. Pauls Square

B3 1RD

Asking Price Of **£195,000**

*First Floor Duplex Apartment*

*5.7% Rental Yield!*

*613 Sq. Ft.*

*Secure & Allocated Parking*





## Property Description

**DESCRIPTION** \*\*\*Great investment opportunity!\*\*\*

An fantastic opportunity to acquire a two bedroom duplex apartment nestled in the heart of the Jewellery Quarter, just off St. Pauls Square within Kings Court. This quaint and quirky apartment is set over two floors and boasts two double bedrooms, a large family bathroom and a stunning open plan living & kitchen area with courtyard facing Juliette balcony.

The development offers greenery in the form of a communal courtyard, secure underground allocated parking and intercom systems, located on the doorstep of St. Pauls Square.

**PARKING** The property has one secure and allocated parking space.

**AREA** The property is located in the heart of Birmingham's Jewellery Quarter, just off St Paul's Square and close to the canal towpaths.

The Jewellery Quarter is a designated conservation area and proposed World Heritage Site and is already a prestigious and highly desired part of Birmingham. It is experiencing further development as some of the old factories are converted into apartments, restaurants and shops. It is only a short distance to all that Birmingham City Centre has to offer including the Colmore Business District.

**JAMES LAURENCE ESTATE AGENTS Agents Note:** We have not tested any of the electrical, central heating or sanitary ware appliances. Purchasers should make their own investigations as to the workings of the relevant items. Floor plans are for identification purposes only and not to scale. All room measurements and mileages quoted in these sales particulars are approximate. All material information stated below has been provided by our client, but we would request all information to be verified by the purchaser's chosen solicitor.

**Tenure:** Leasehold

**Services:** All mains' services are connected to the property.

**Local Authority:** Birmingham City Council

**Council Tax Band:** D

**Service Charge:** £2,043.72. Per Annum.

**Ground Rent:** £243.72 Per Annum

**Ground Rent Review Period:** TBC



## Floor Layout

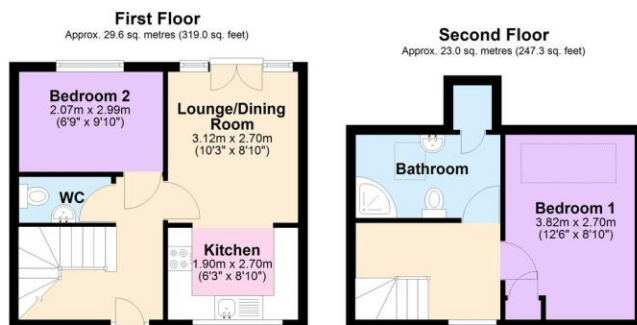

Total area: approx. 52.6 sq. metres (566.3 sq. feet)

Total approx. floor area 613 sq ft (57 sq m)

Whilst every attempt has been made to ensure the accuracy of the floor plan contained here, measurements of doors, windows, rooms and any other items are approximate and no responsibility is taken for any error, omission, or mis-statement. This plan is for illustrative purposes only and should be used as such by any prospective purchaser. The services, systems and appliances shown have not been tested and no guarantee as to their operability or efficiency can be given. Made with Metropix ©2019.

Energy Efficiency Rating		Current	Potential
Very energy efficient - lower running costs			
(92-100)	<b>A</b>		
(81-91)	<b>B</b>		
(69-80)	<b>C</b>		
(55-68)	<b>D</b>		76
(39-54)	<b>E</b>	64	
(21-38)	<b>F</b>		
(1-20)	<b>G</b>		
Not energy efficient - higher running costs			
England, Scotland & Wales			
EU Directive 2002/91/EC			

Birmingham City Centre Branch

0121 6044060

info@jameslaurenceuk.com

33 Ludgate Hill, Birmingham, B3 1EH

*James Laurence*  
**James Laurence**

*Agents Note:* Whilst every care has been taken to prepare these sales particulars, they are for guidance purposes only. All measurements are approximate and for general guidance purposes only and whilst every care has been taken to ensure their accuracy, they should not be relied upon and potential buyers are advised to recheck the measurements