

Water Street Court

58 Water Street

Jewellery Quarter

B3 1BJ

Asking Price Of **£270,000**

Ground Floor Apartment

Private Patio Area

Two Double Bedrooms

Ensuite To Master Bedroom





Property Description

DESCRIPTION Located just a stones throw from St Pauls Square, this lovely two bedroom ground floor apartment boasts an open plan living area with fitted kitchen, a spacious master bedroom with ensuite, further double bedroom, family bathroom and a fantastic private patio area. The property also benefits from secure, allocated parking and concierge.

LOCATION The property is located in the heart of Birmingham's Jewellery Quarter, just a few steps from St Paul's Square and close to the canal towpaths. You'll be ideally placed to enjoy the eclectic mix of restaurants, bars, cafes and shops that Birmingham's historic Jewellery Quarter has to offer.

The Central Business District is just a short walk away, as are many of Birmingham's popular amenities including Selfridges, the Bullring shopping centre, Brindley Place and a variety of independent shops and Michelin star restaurants. If you're looking to travel further, Birmingham Snow Hill railway station is a 5 minute walk away, with New Street and Moor Street Stations residing within a 15 minute walk of the property; offering regular links to London, Manchester, Edinburgh and beyond. The property also falls in walking distance of the proposed HS2 station which will allow you to travel to and from the capital in just 49 minutes.

There are brilliant links to the national motorway network, with excellent access to Birmingham International Airport and The National Exhibition Centre. The A38 Aston Expressway is only around half a mile away and leads directly onto Junction 6 of the M6 which itself is only some 3.5 miles distant.

JAMES LAURENCE ESTATE AGENTS MATERIAL INFORMATION Agents Note: We have not tested any of the electrical, central heating or sanitary ware appliances. Purchasers should make their own investigations as to the workings of the relevant items. Floor plans are for identification purposes only and not to scale. All room measurements and mileages quoted in these sales particulars are approximate. All material information stated below has been provided by our client, but we would request all information to be verified by the purchaser's chosen solicitor.

Fixtures and Fittings: All those items mentioned in these particulars by way of fixtures and fittings are deemed to be included in the sale price. Others, if any, are excluded. However, we would always advise that this is confirmed by the purchaser at the point of offer.

Tenure: Leasehold
Local Authority: Birmingham City Council
Council Tax Band - D
Service Charge - £2176 per annum
Ground Rent - £350 per annum
Length of Lease - 132 Years Remaining



Floor Layout

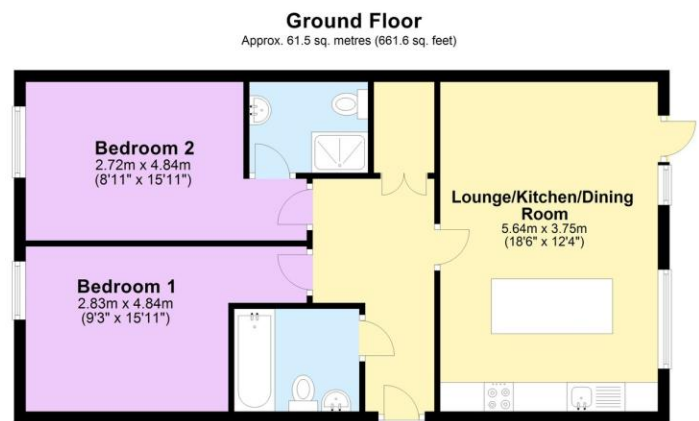

Total area: approx. 61.5 sq. metres (661.6 sq. feet)

Total approx. floor area 662 sq ft (61 sq m)

Whilst every attempt has been made to ensure the accuracy of the floor plan contained here, measurements of doors, windows, rooms and any other items are approximate and no responsibility is taken for any error, omission, or mis-statement. This plan is for illustrative purposes only and should be used as such by any prospective purchaser. The services, systems and appliances shown have not been tested and no guarantee as to their operability or efficiency can be given. Made with Metropix ©2019.



Birmingham City Centre Branch

0121 6044060

info@jameslaurenceuk.com

37-39 Ludgate Hill, Birmingham, B3 1EH

JL
James Laurence

Agents Note: Whilst every care has been taken to prepare these sales particulars, they are for guidance purposes only. All measurements are approximate and for general guidance purposes only and whilst every care has been taken to ensure their accuracy, they should not be relied upon and potential buyers are advised to recheck the measurements